

- Notes:**
1. M16 8.8 Galv bolts for all 18Ø steel to steel connections
 2. M20 8.8 Galv bolts for all 22Ø OR 24Ø steel to steel connections
 3. All site welds to be coated with primer (Cold Gal for external)
 4. All hold down bolts M16 Galvanised chemset , 150mm embed U.N.O
 5. All welds to be 6CFW U.N.O
 6. Lines next to connections indicate cleat side

Rev	By	Date	Description
3	AC	24/03/2023	PC1 PROFILE MODIFICATION
2	MN	17/03/2023	ISSUE FOR FABRICATION
1	MN	14/03/2023	ISSUE FOR FABRICATION
B	AC	01/03/2023	REVISED - ISSUE FOR APPROVAL
A	AC	23/02/2023	ISSUE FOR REVIEW

CUSTOMER
JOB ADDRESS
SUBURB

GENERAL ARRANGEMENT

UNIT 1

Scale: 1:45
 Project No: 7MADELEY

Develle Structures
 14/1 Independent way
 Ravenhall, VIC, 3023
 Contact: Andrew Cimballejevic
 Mobile: 0414 482 613

Develle Structures

Drawn By: AC
 Checked By: MN
 Approved By:

Drawing No: GA01
 Size: A2
 Rev: 3

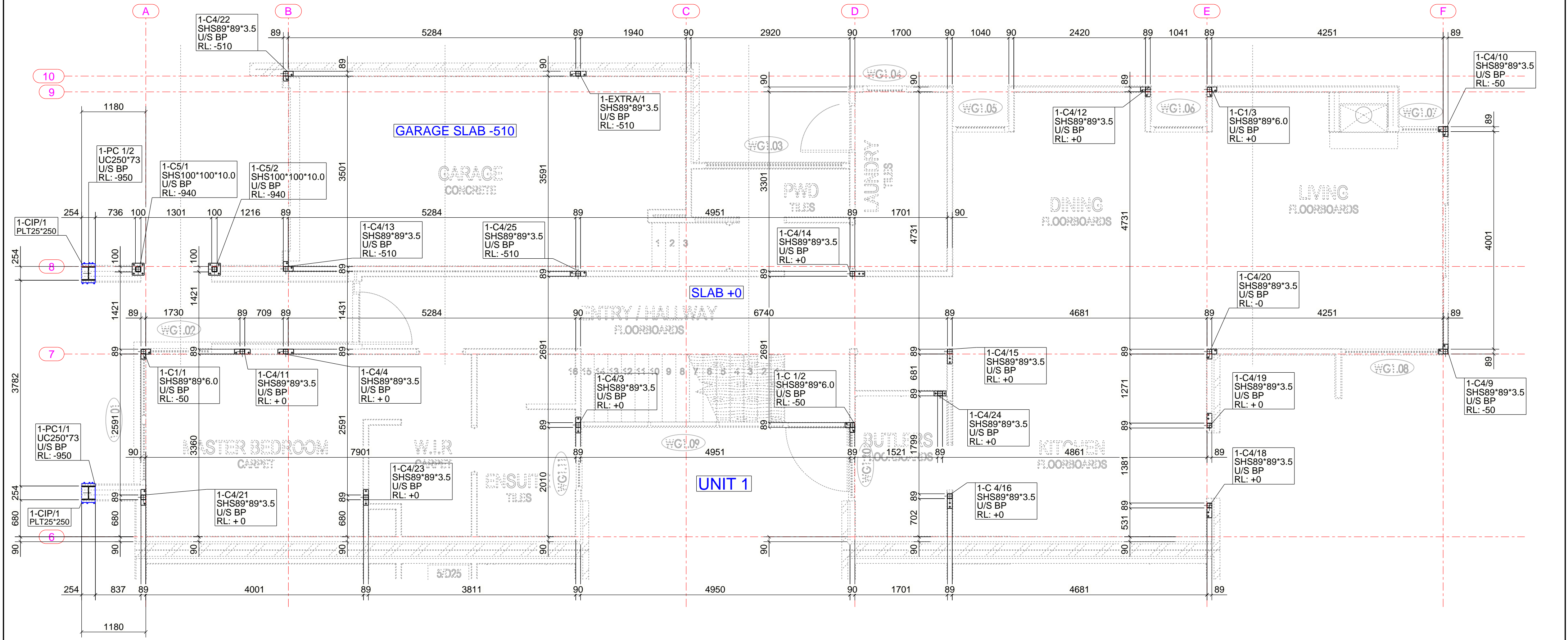
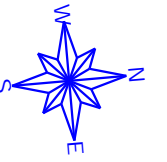

- Notes:**
1. M16 8.8 Galv bolts for all 18Ø steel to steel connections
 2. M20 8.8 Galv bolts for all 22Ø OR 24Ø steel to steel connections
 3. All site welds to be coated with primer (Cold Gal for external)
 4. All hold down bolts M16 Galvanised chemset , 150mm embed U.N.O
 5. All welds to be 6CFW U.N.O
 6. Lines next to connections indicate cleat side

Rev	By	Date	Description
3	AC	24/03/2023	PC1 PROFILE MODIFICATION
2	MN	17/03/2023	ISSUE FOR FABRICATION
1	MN	14/03/2023	ISSUE FOR FABRICATION
B	AC	01/03/2023	REVISED - ISSUE FOR APPROVAL
A	AC	23/02/2023	ISSUE FOR REVIEW

CUSTOMER
JOB ADDRESS
SUBURB

COLUMN MARKING PLAN

UNIT 1

Scale: 1:50 Project No: 7MADELEY

Develle Structures
 14/1 Independent way
 Ravenhall, VIC, 3023
 Contact: Andrew Cimbaljevic
 Mobile: 0414 482 613

Drawn By: AC
 Checked By: MN
 Approved By:

Drawing No: MP01 Size: A2 Rev: 3

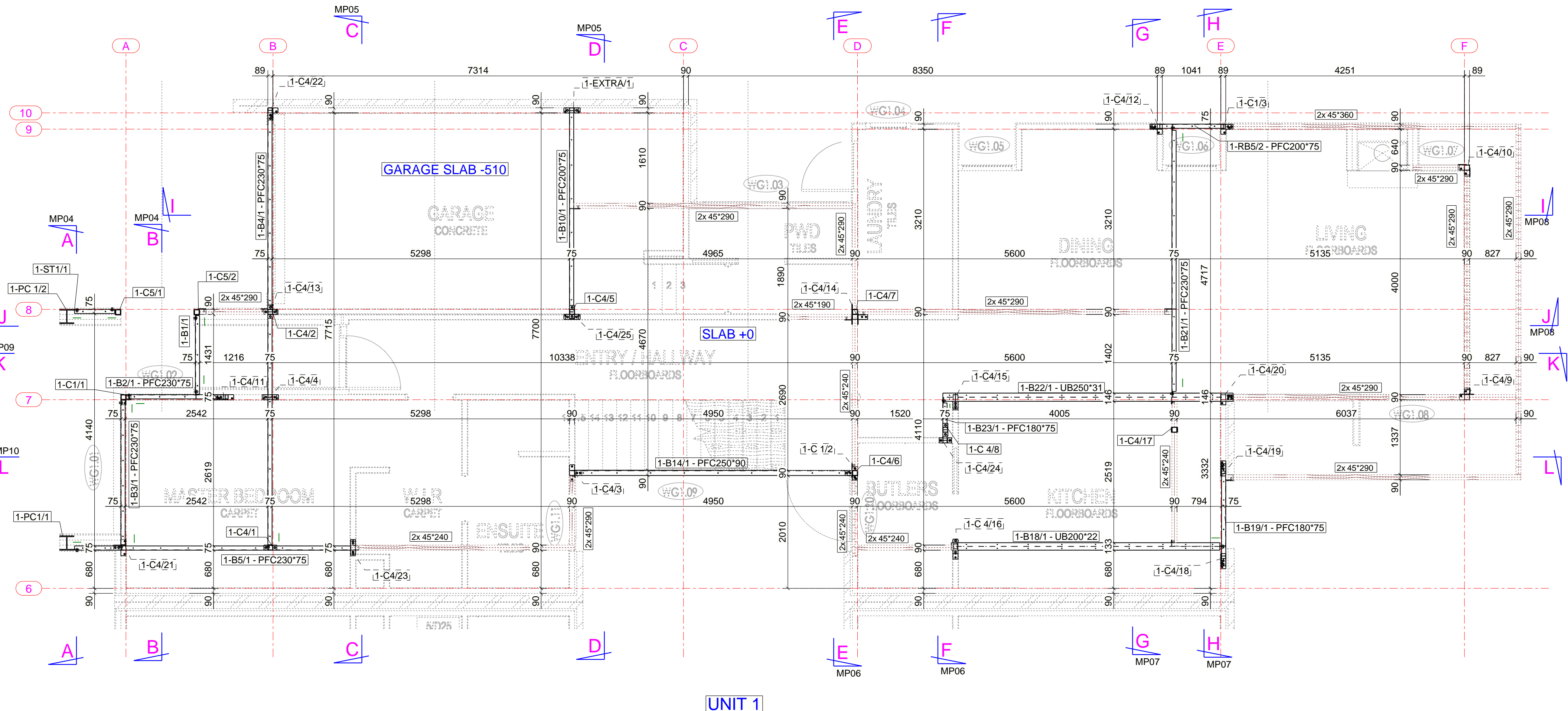
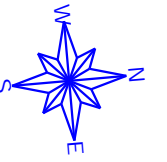

- Notes:**
1. M16 8.8 Galv bolts for all 18Ø steel to steel connections
 2. M20 8.8 Galv bolts for all 22Ø OR 24Ø steel to steel connections
 3. All site welds to be coated with primer (Cold Gal for external)
 4. All hold down bolts M16 Galvanised chemset , 150mm embed U.N.O
 5. All welds to be 6CFW U.N.O
 6. Lines next to connections indicate cleat side

Rev	By	Date	Description
3	AC	24/03/2023	PC1 PROFILE MODIFICATION
2	MN	17/03/2023	ISSUE FOR FABRICATION
1	MN	14/03/2023	ISSUE FOR FABRICATION
B	AC	01/03/2023	REVISED - ISSUE FOR APPROVAL
A	AC	23/02/2023	ISSUE FOR REVIEW

CUSTOMER
JOB ADDRESS
SUBURB

BEAM MARKING PLAN

UNIT 1

Scale: 1:50 Project No: 7MADELEY

Develle Structures
 14/1 Independent way
 Ravenhall, VIC, 3023
 Contact: Andrew Cimballejevic
 Mobile: 0414 482 613

Drawn By: AC
 Checked By: MN
 Approved By:

Drawing No: MP02 Size: A2 Rev: 3

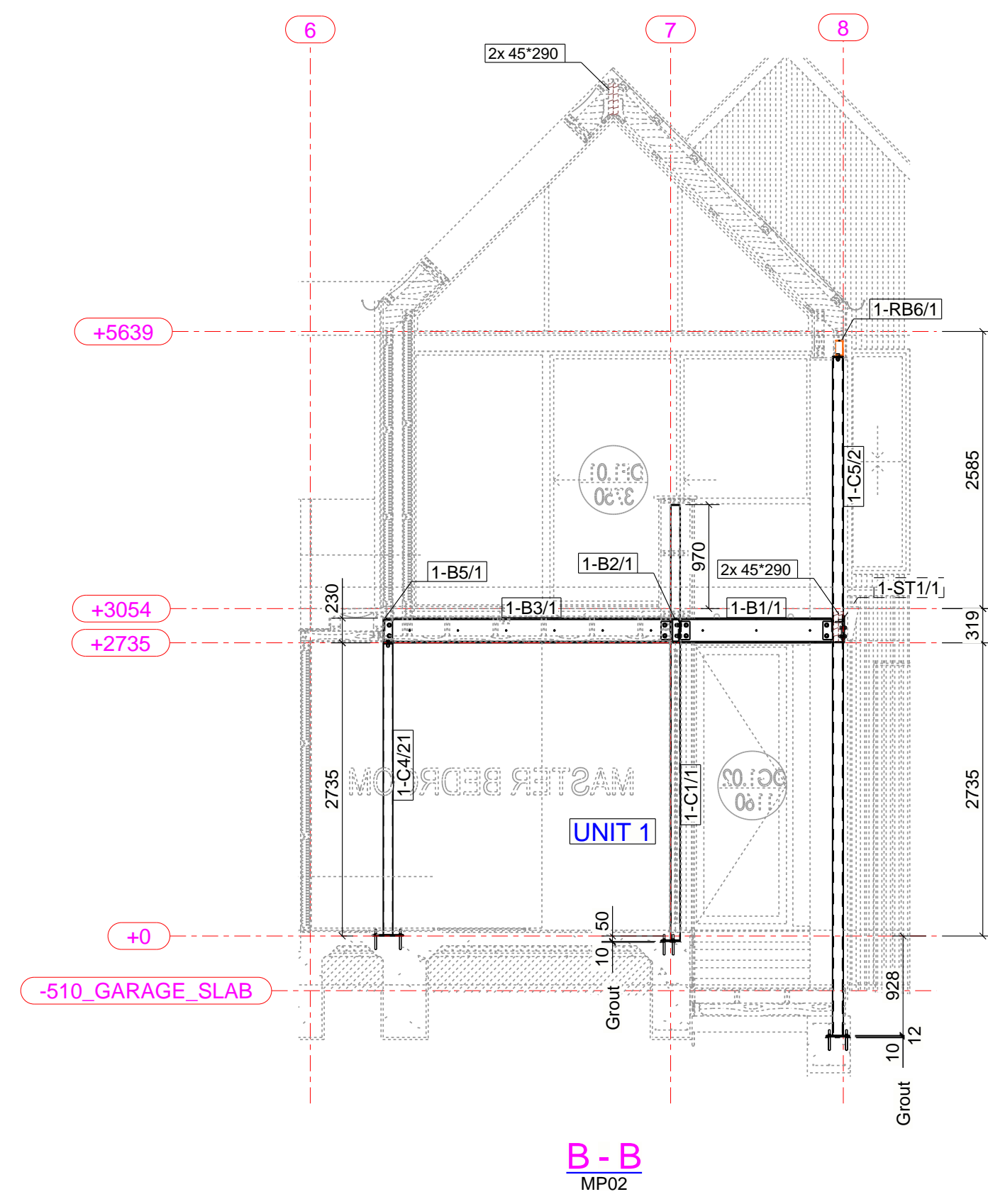
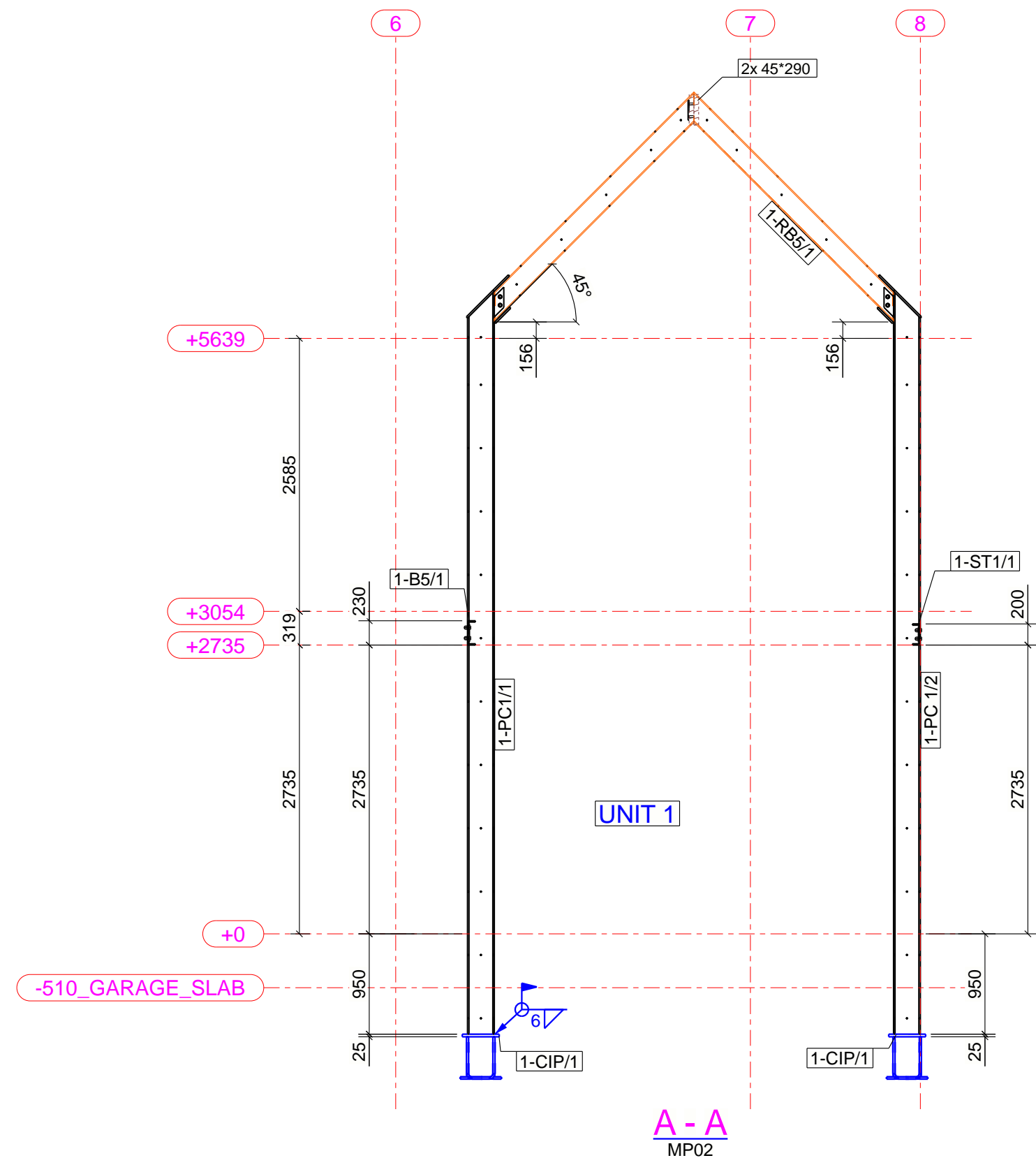

- Notes:**
1. M16 8.8 Galv bolts for all 18Ø steel to steel connections
 2. M20 8.8 Galv bolts for all 22Ø OR 24Ø steel to steel connections
 3. All site welds to be coated with primer (Cold Gal for external)
 4. All hold down bolts M16 Galvanised chemset , 150mm embed U.N.O
 5. All welds to be 6CFW U.N.O
 6. Lines next to connections indicate cleat side

Rev	By	Date	Description
3	AC	24/03/2023	PC1 PROFILE MODIFICATION
2	MN	17/03/2023	ISSUE FOR FABRICATION
1	MN	14/03/2023	ISSUE FOR FABRICATION
B	AC	01/03/2023	REVISED - ISSUE FOR APPROVAL
A	AC	23/02/2023	ISSUE FOR REVIEW

CUSTOMER
JOB ADDRESS
SUBURB

SECTIONS
UNIT 1

Scale: 1:50 Project No: 7MADELEY

Develle Structures
14/1 Independent way
Ravenhall, VIC, 3023
Contact: Andrew Cimbaljevic
Mobile: 0414 482 613

Drawn By: AC
Checked By: MN
Approved By:

Drawing No: MP04 Size: A2 Rev: 3

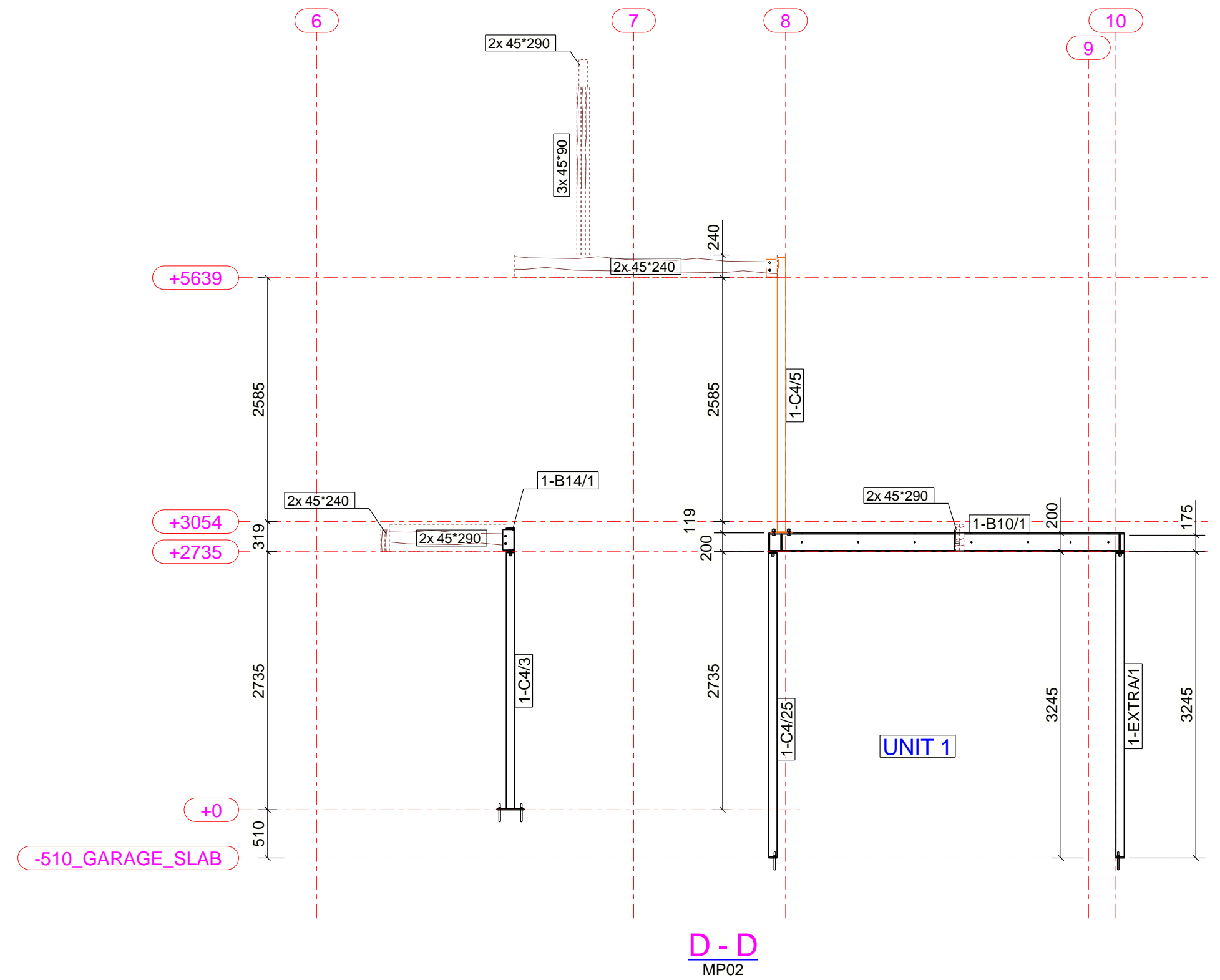
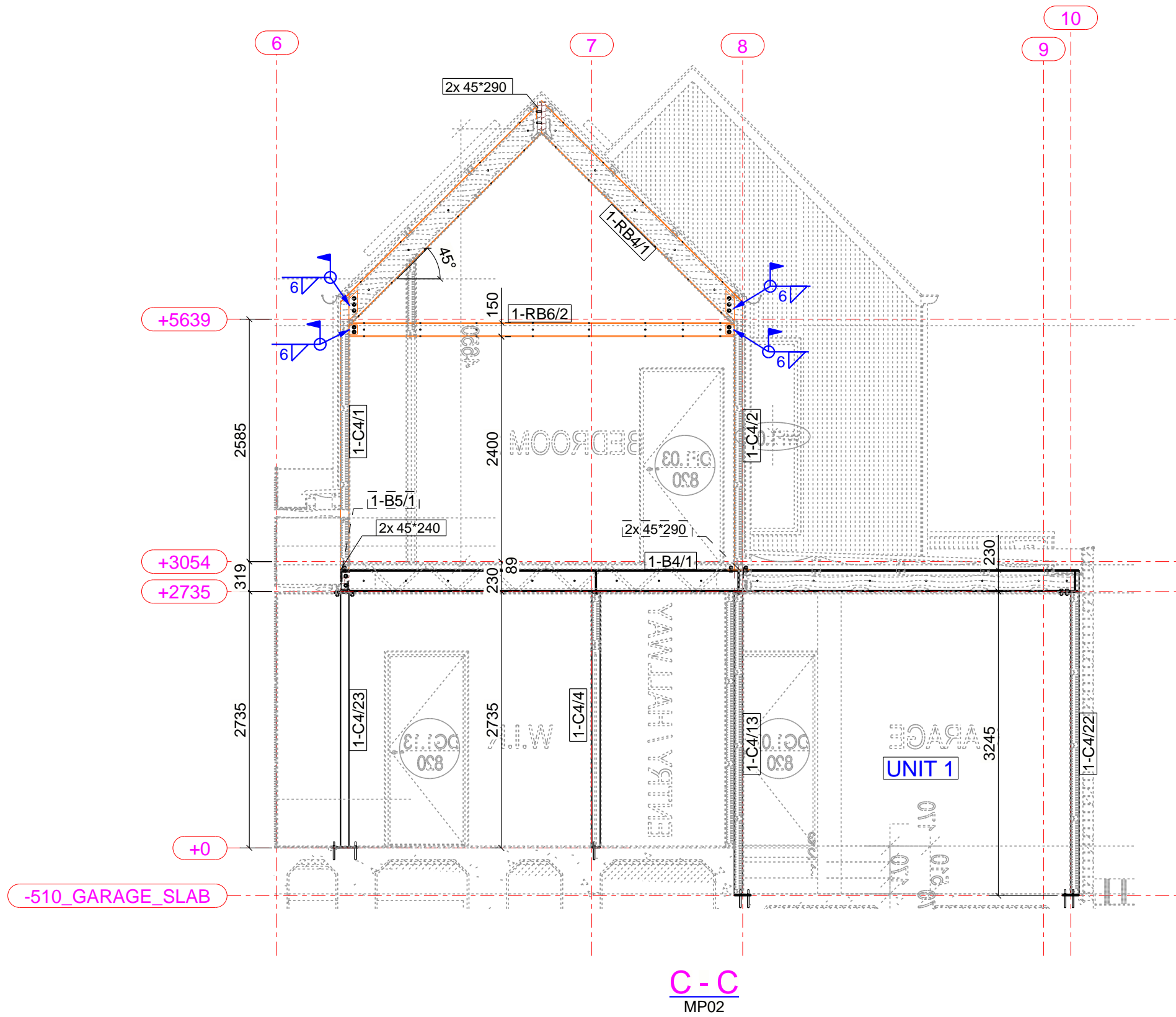

Notes:

1. M16 8.8 Galv bolts for all 18Ø steel to steel connections
2. M20 8.8 Galv bolts for all 22Ø OR 24Ø steel to steel connections
3. All site welds to be coated with primer (Cold Gal for external)
4. All hold down bolts M16 Galvanised chemset , 150mm embed U.N.O
5. All welds to be 6CFW U.N.O
6. Lines next to connections indicate cleat side

Rev	By	Date	Description
3	AC	24/03/2023	PC1 PROFILE MODIFICATION
2	MN	17/03/2023	ISSUE FOR FABRICATION
1	MN	14/03/2023	ISSUE FOR FABRICATION
B	AC	01/03/2023	REVISED - ISSUE FOR APPROVAL
A	AC	23/02/2023	ISSUE FOR REVIEW

CUSTOMER
JOB ADDRESS
SUBURB

Develle Structures
14/1 Independent way
Ravenhall, VIC, 3023
Contact: Andrew Cimbaljevic
Mobile: 0414 482 613



SECTIONS
UNIT 1

Drawn By: **AC**
Checked By: **MN**
Approved By:

Scale: **1:50** Project No: **7MADELEY**

Drawing No: **MP05** Size: **A2** Rev: **3**

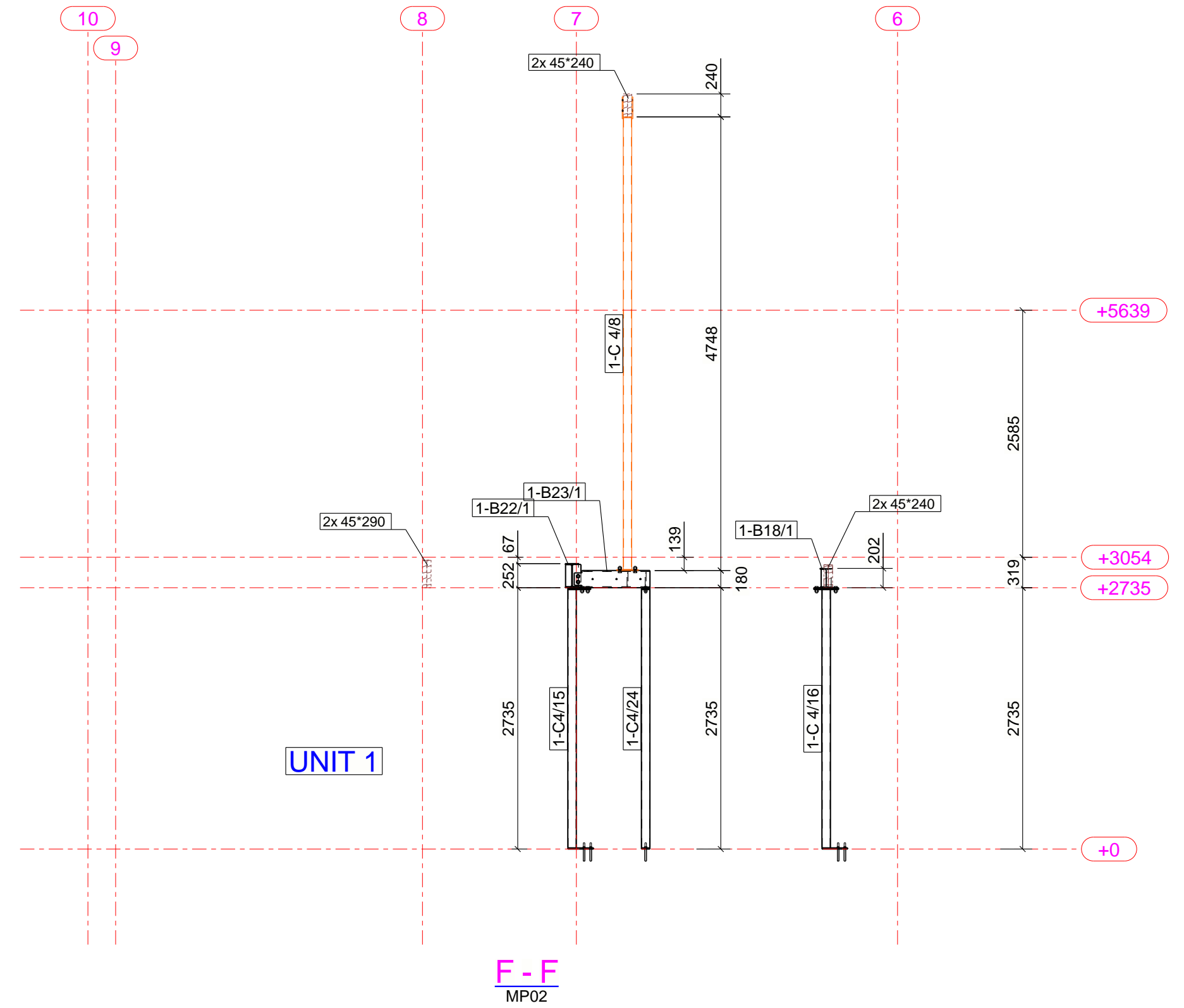
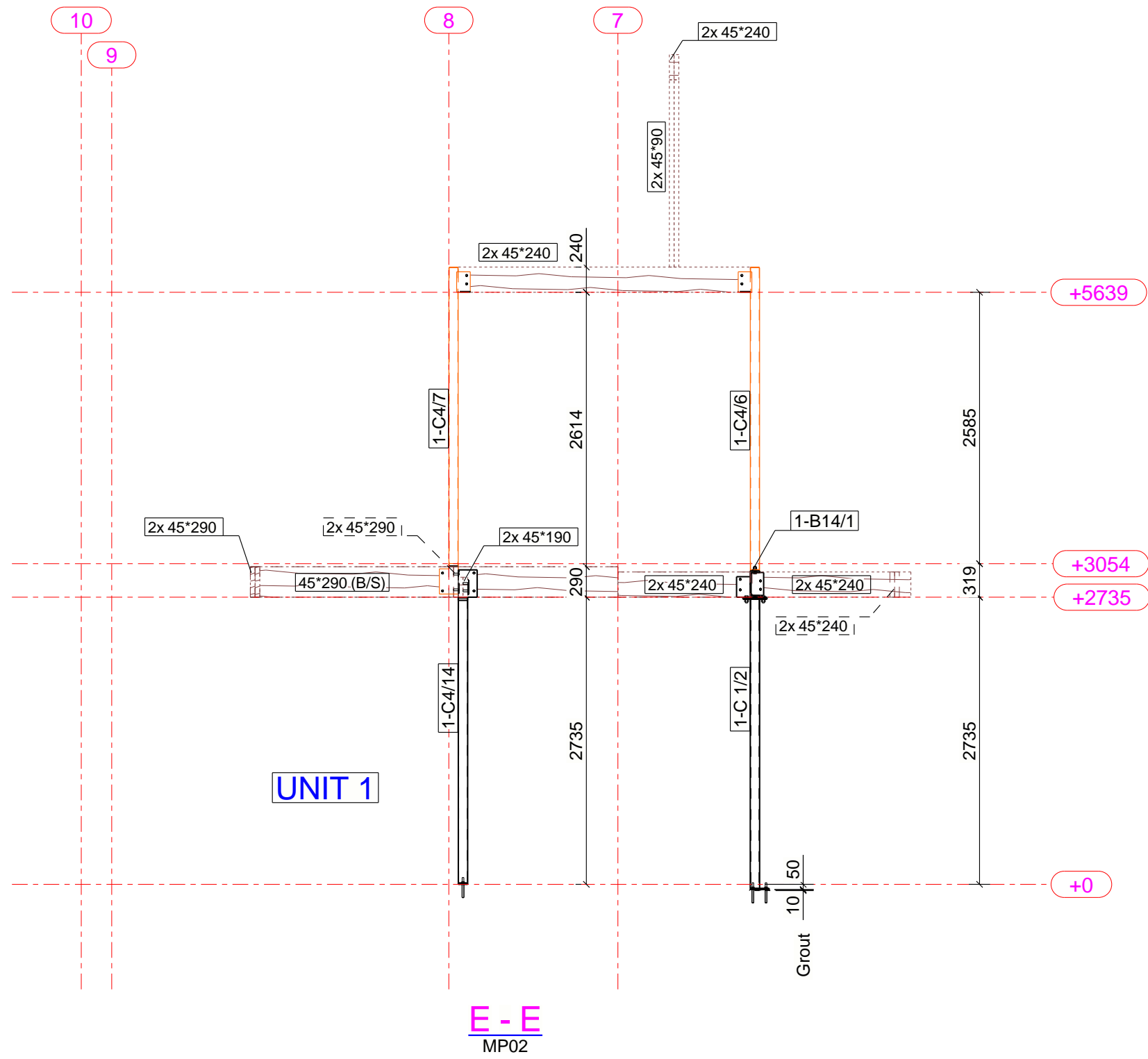

- Notes:**
1. M16 8.8 Galv bolts for all 18Ø steel to steel connections
 2. M20 8.8 Galv bolts for all 22Ø OR 24Ø steel to steel connections
 3. All site welds to be coated with primer (Cold Gal for external)
 4. All hold down bolts M16 Galvanised chemset , 150mm embed U.N.O
 5. All welds to be 6CFW U.N.O
 6. Lines next to connections indicate cleat side

Rev	By	Date	Description
3	AC	24/03/2023	PC1 PROFILE MODIFICATION
2	MN	17/03/2023	ISSUE FOR FABRICATION
1	MN	14/03/2023	ISSUE FOR FABRICATION
B	AC	01/03/2023	REVISED - ISSUE FOR APPROVAL
A	AC	23/02/2023	ISSUE FOR REVIEW

CUSTOMER
JOB ADDRESS
SUBURB

SECTIONS
UNIT 1

Scale: 1:50 Project No: 7MADELEY

Develle Structures
14/1 Independent way
Ravenhall, VIC, 3023
Contact: Andrew Cimbaljevic
Mobile: 0414 482 613

Drawn By: AC
Checked By: MN
Approved By:

Drawing No: MP06 Size: A2 Rev: 3

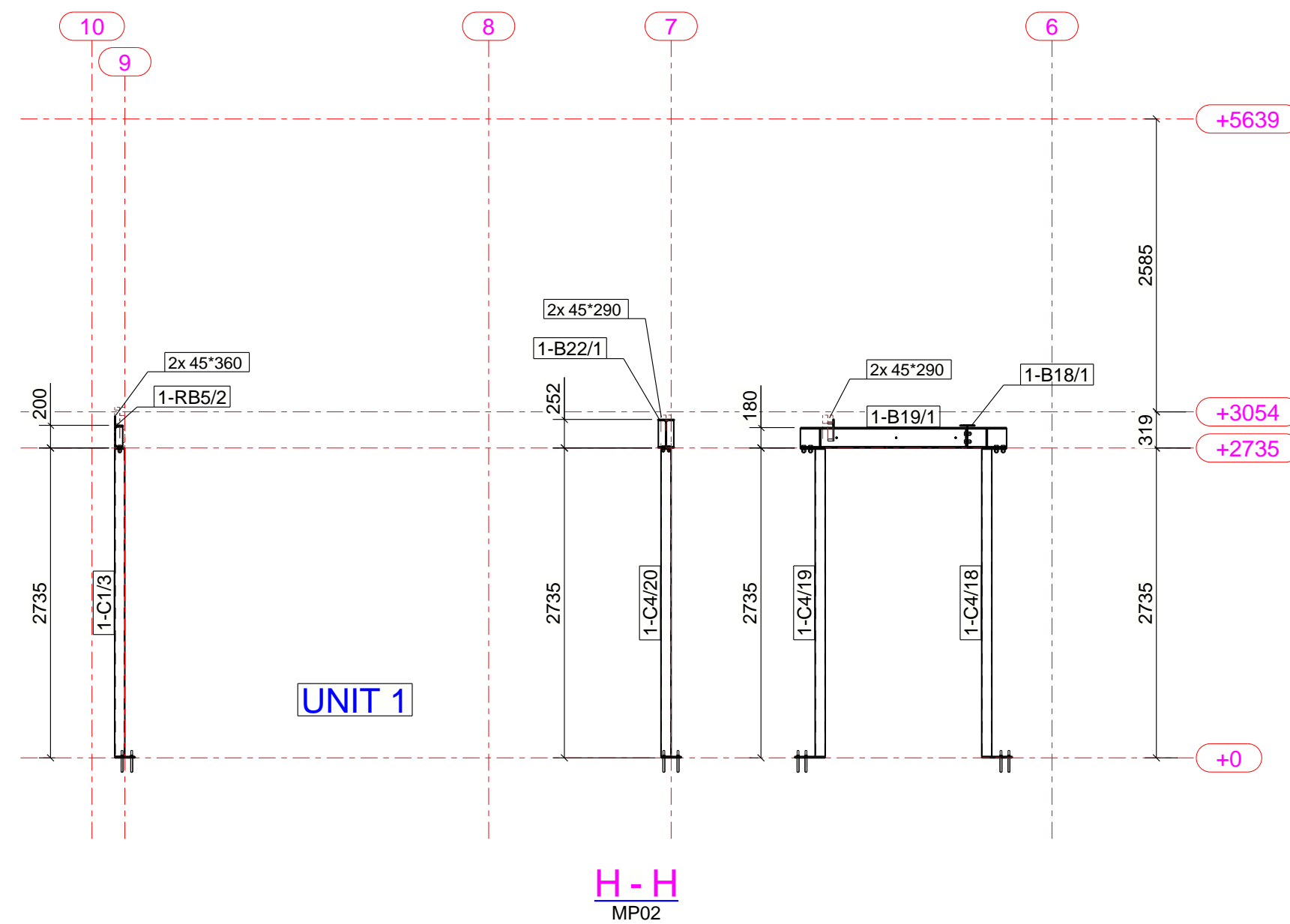
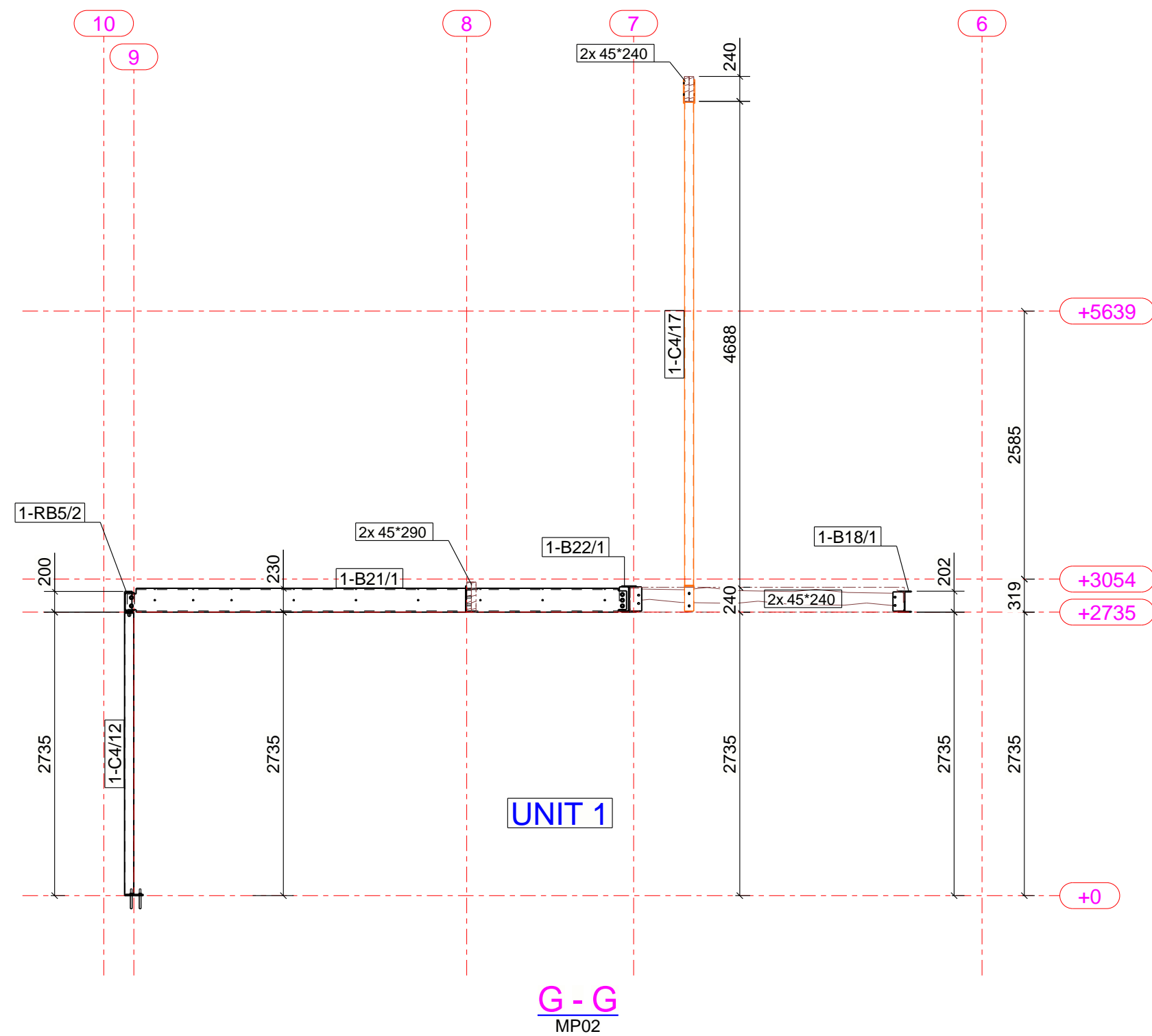

Rev	By	Date	Description	CUSTOMER	Develle Structures
3	AC	24/03/2023	PC1 PROFILE MODIFICATION	JOB ADDRESS	14/1 Independent way
2	MN	17/03/2023	ISSUE FOR FABRICATION	SUBURB	Ravenhall, VIC, 3023
1	MN	14/03/2023	ISSUE FOR FABRICATION		Contact: Andrew Cimbaljevic
B	AC	01/03/2023	REVISED - ISSUE FOR APPROVAL		Mobile: 0414 482 613
A	AC	23/02/2023	ISSUE FOR REVIEW		
				SECTIONS	Drawn By: AC
				UNIT 1	Checked By: MN
				Scale: 1:50	Approved By:
				Project No: 7MADELEY	Drawing No: MP07
					Size: A2
					Rev: 3

Notes:

- M16 8.8 Galv bolts for all 18Ø steel to steel connections
- M20 8.8 Galv bolts for all 22Ø OR 24Ø steel to steel connections
- All site welds to be coated with primer (Cold Gal for external)
- All hold down bolts M16 Galvanised chemset , 150mm embed U.N.O
- All welds to be 6CFW U.N.O
- Lines next to connections indicate cleat side

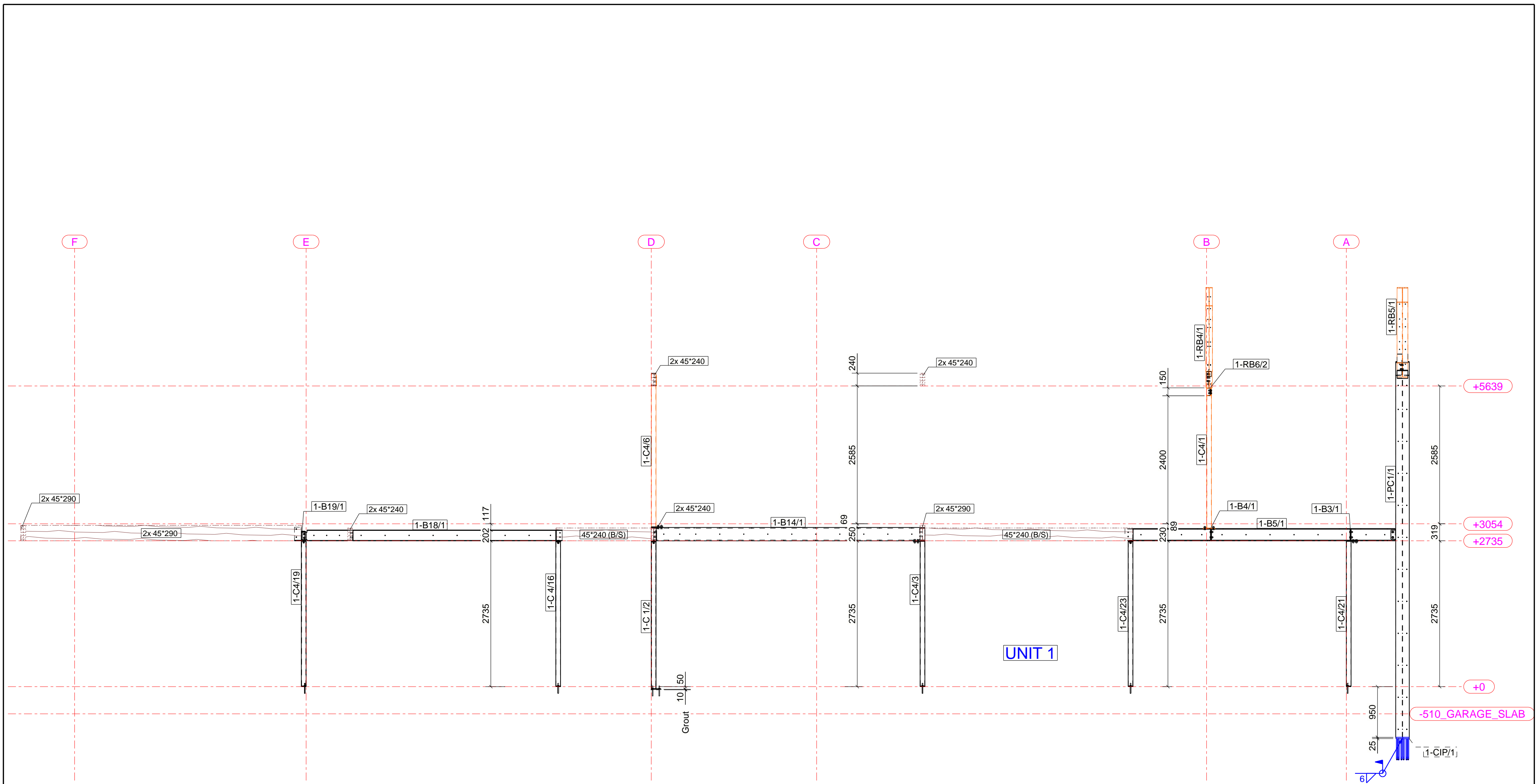

L-L
MP02

- Notes:**
1. M16 8.8 Galv bolts for all 18Ø steel to steel connections
 2. M20 8.8 Galv bolts for all 22Ø OR 24Ø steel to steel connections
 3. All site welds to be coated with primer (Cold Gal for external)
 4. All hold down bolts M16 Galvanised chemset , 150mm embed U.N.O
 5. All welds to be 6CFW U.N.O
 6. Lines next to connections indicate cleat side

Rev	By	Date	Description
3	AC	24/03/2023	PC1 PROFILE MODIFICATION
2	MN	17/03/2023	ISSUE FOR FABRICATION
1	MN	14/03/2023	ISSUE FOR FABRICATION
B	AC	01/03/2023	REVISED - ISSUE FOR APPROVAL
A	AC	23/02/2023	ISSUE FOR REVIEW

CUSTOMER
JOB ADDRESS
SUBURB

SECTIONS
UNIT 1

Scale: 1:50
Project No: 7MADELEY

Develle Structures
14/1 Independent way
Ravenhall, VIC, 3023
Contact: Andrew Cimbaljevic
Mobile: 0414 482 613

Drawn By: AC
Checked By: MN
Approved By:

Drawing No: MP10
Size: A2
Rev: 3