

PHASE	QTY.
1	1
GRID LOCATION	
1-PC1/2	<A/8

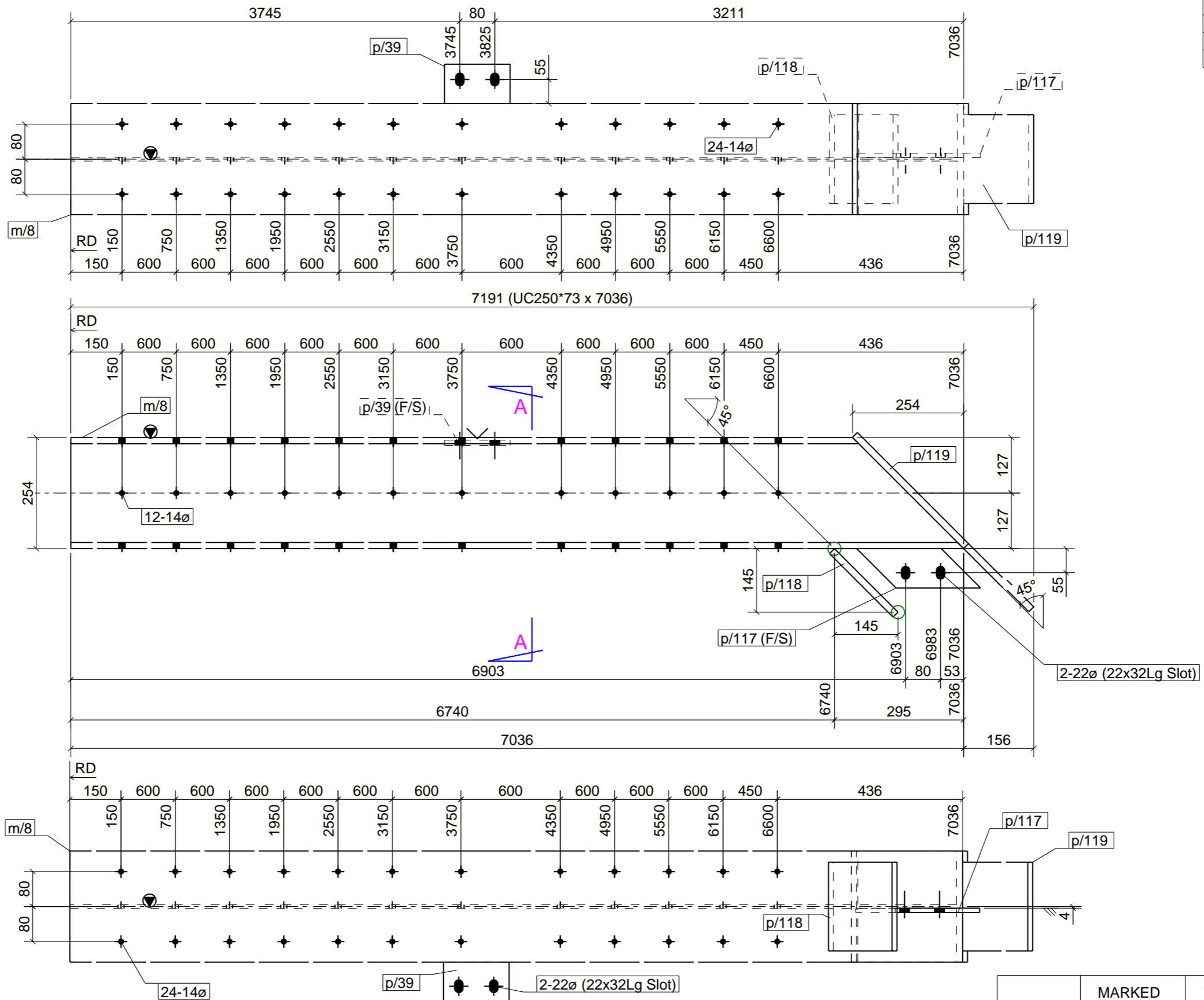

ALL WELDS TO BE 6CFW U.N.O (AS/NZ 1554)  
 REMOVE ALL BURRS BEFORE PAINTING/GALVANISING  
 MARK BEAM SIDE ON CONNECTIONS PLATES MARKED <  
 STAMP/MARK BEAMS ACCORDINGLY

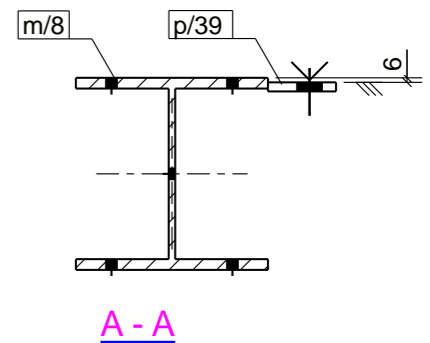

**MATERIAL LIST**

ITEM	No.OFF	SECTION	LENGTH	GRADE	WEIGHT(kg)	AREA(m <sup>2</sup> )
m/8	1	UC250*73	7036	300PLUS	512.9	10.4
p/39	1	FL12*90	150	250	1.3	0.0
p/117	1	FL10*90	283	250	1.4	0.0
p/118	1	PLT16*203	205	250	5.2	0.1
p/119	1	PLT16*254	564	250	16.7	0.3
TOTAL:					537.5	10.9

**1 COLUMN[S] REQUIRED MK 1-PC1/2**  
**Finish - PRIME PAINTED**

- Notes:
- ALL WELDS TO BE 6CFW U.N.O
  - MARK ASSEMBLIES AS SHOWN ON DRAWINGS
  - MARK BEAM SIDE ON CLEATS WHERE INDICATED
  - MARK NORTH SIDE AS INDICATED
  - QUESTIONS - CALL ANDREW ON 0414 482 613

Rev	By	Date	Description
3	AC	24/03/2023	PC1 PROFILE MODIFICATION
2	MN	17/03/2023	ISSUE FOR FABRICATION
1	MN	15/03/2023	ISSUE FOR FABRICATION
A	MN	02/03/2023	ISSUE FOR APPROVAL

	MARKED	TACKED	CHECKED	FABRICATED
DATE:				
INITIALS:				

**CUSTOMER**  
 JOB ADDRESS  
 SUBURB

**COLUMN**

Scale: 1:10    Project No: 7MADELEY    Assembly No: 1-PC1/2    Qty: 1    Size: A3    Sheet No: N/A    Rev: 3

Develle Structures  
 14/1 Independent way  
 Ravenhall, VIC, 3023  
 Contact: Andrew Cimbaljevic  
 Mobile: 0414 482 613

Drawn By: AC  
 Checked By: MN  
 Approved By: